

# MULTIPLE MEDIA DISPLAYER ASY 422

## ASSEMBLY INSTRUCTIONS PARTS IDENTIFICATION

The Multiple Media Displayer has a load capacity of 200 lbs. per shelf, with maximum capacity per section being 1650 lbs. Please see chart here to see the required number of spanners to fixture height.

Displayer height	# of spanners per Wall	# of spanners per Gondola
42"	6	6
48"	7	8
54"	7	8
60"	8	10
66"	8	10
72"	8	10
78"	9	12
84"	9	12

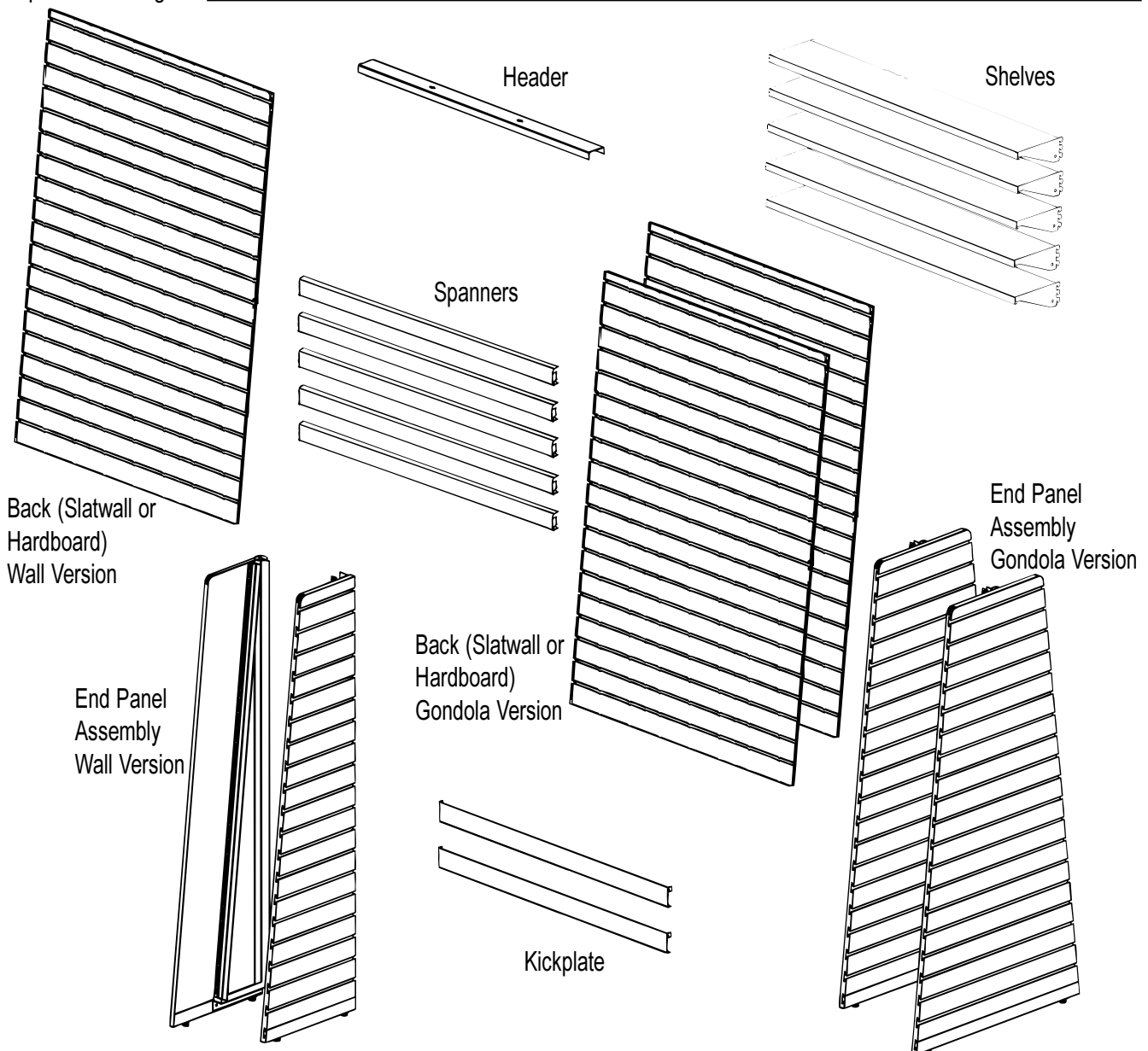

# MULTIPLE MEDIA DISPLAYER ASY 422

## ASSEMBLY INSTRUCTIONS

### INSTRUCTIONS

#### WALL UNIT:

It is recommended that this product be assembled with 2-3 personnel. A rubber mallet may aid in assembly.

(For Gondola unit, see pages 4 & 5)

Example:  
Insert Spanners as shown.

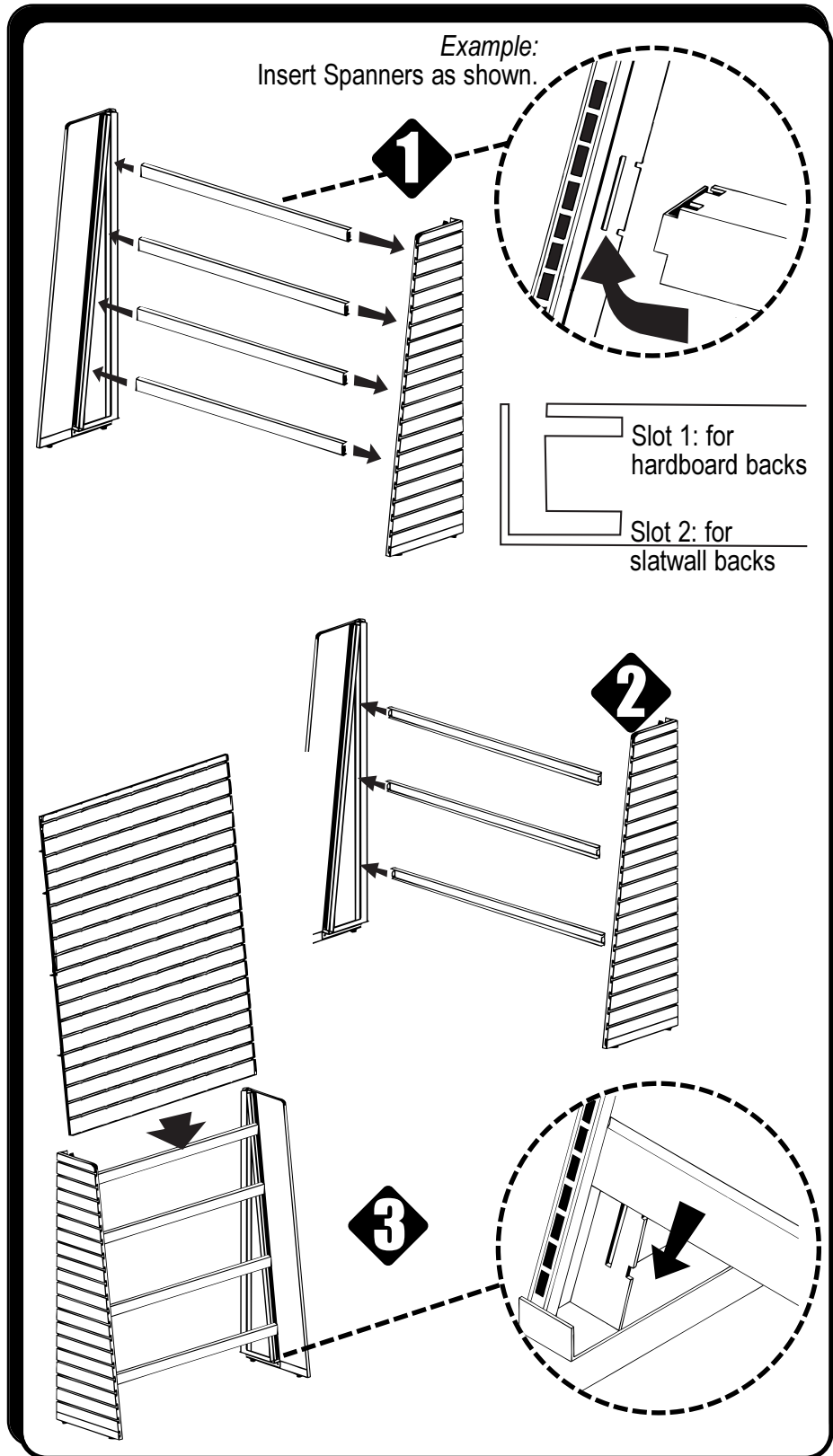

**1** Take both End Panels and attach the Spanners to the End Panel Assembly Post.

**2** Install Spanners to the back section of the End Panel Assembly Post for balance as shown.

**3** Install Back Panel as shown, between End Panels. Note: Back Panel will rests in the pocket of the bottom flange as shown.

# MULTIPLE MEDIA DISPLAYER ASY 422

## ASSEMBLY INSTRUCTIONS

**4**

*This is necessary for Slatwall only.* TEK screws should be applied between slats every 2 feet into the metal of the Panel Assembly Post.

**5**

Place the Header as shown.

**6**

Place the Kickplate as shown.

**7**

Place the shelf in the slots of the Panel Assembly Post as shown. Repeat the procedure for additional shelves.

**ASSEMBLY COMPLETE**

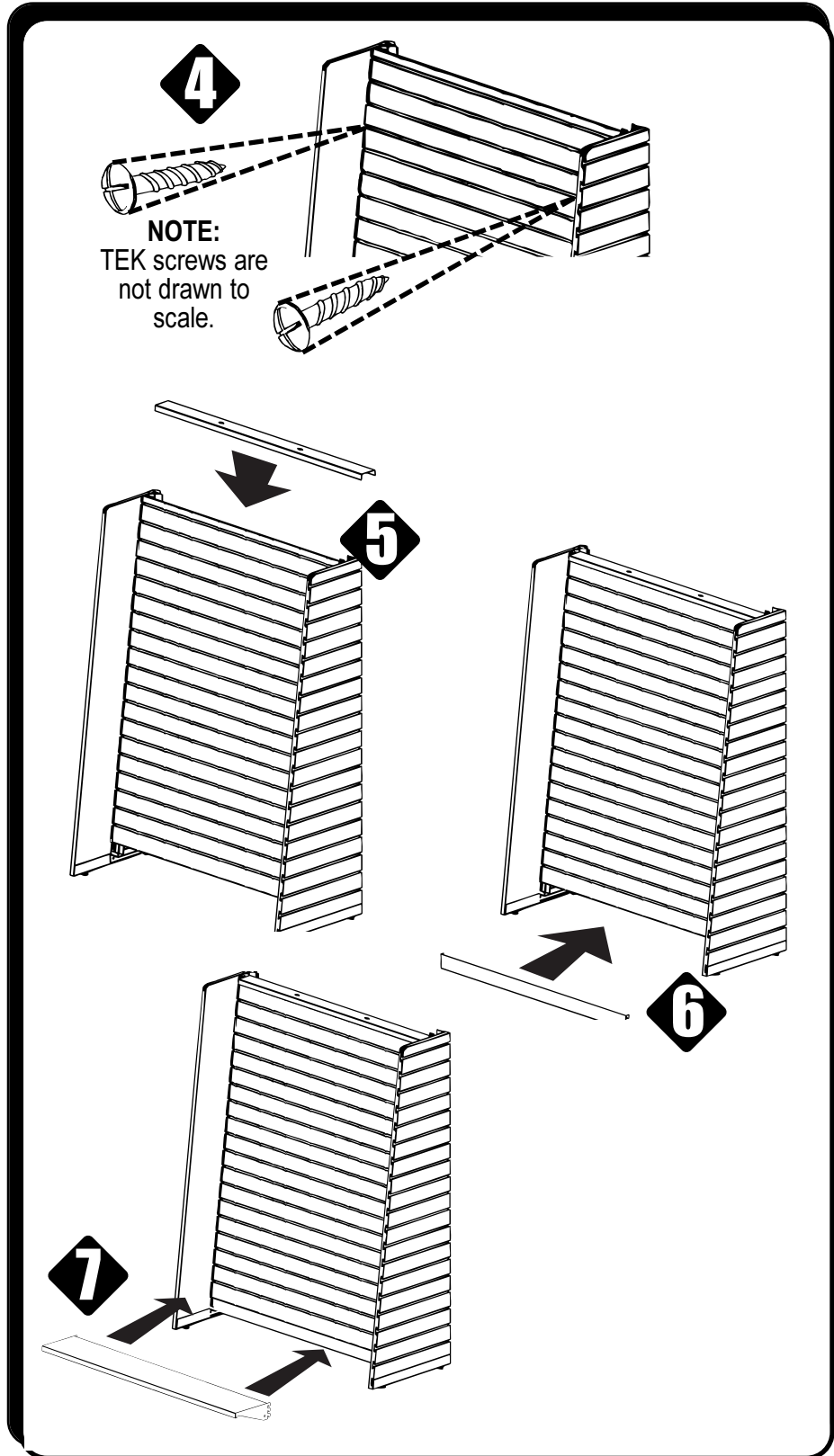

# MULTIPLE MEDIA DISPLAYER ASY 422

## ASSEMBLY INSTRUCTIONS

### INSTRUCTIONS

#### GONDOLA UNIT:

It is recommended that this product be assembled with 2-3 personnel. A rubber mallet may aid in assembly.

(For Wall unit, see pages 2 & 3)

**1** Install Spanners to the back section of the End Panel Assembly Post for balance as shown.

**2** Take both End Panels and attach the Spanners to the End Panel Assembly Post.

**3** Install Back Panel as shown, between End Panels. Repeat for opposite side. *Note: Back Panel will rests in the pocket of the bottom flange as shown.*

