

WIDE SPAN SHELVING

PAGE 1 OF 10

ASY 061

INSTALLATION INSTRUCTIONS

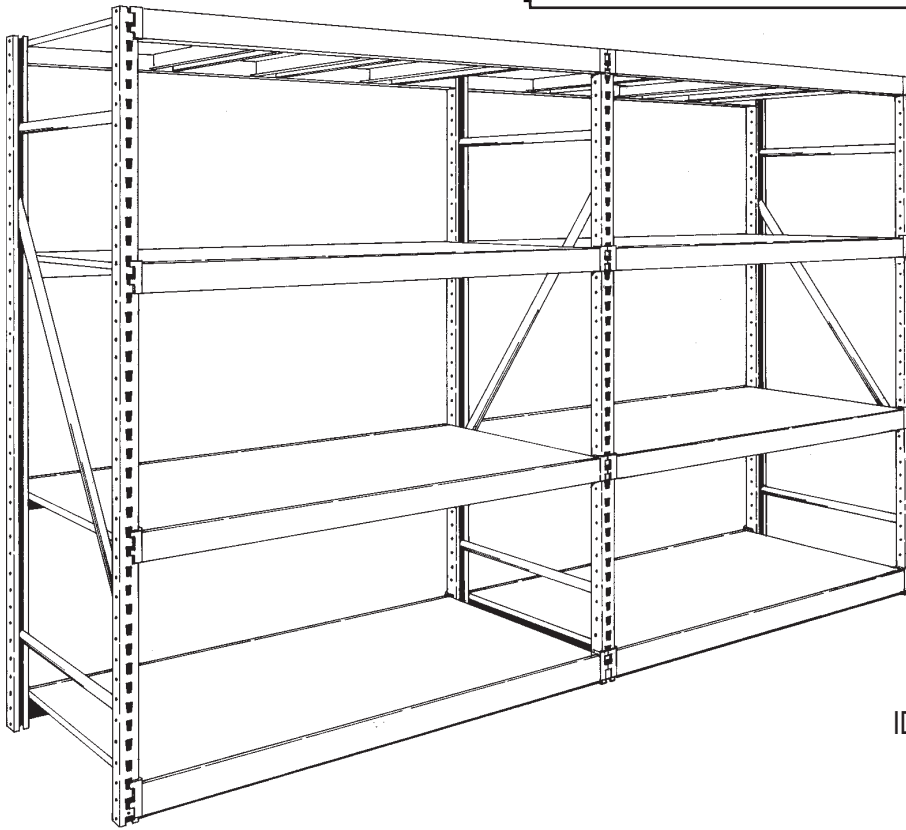

PAGE 2-3
PARTS
IDENTIFICATION

PAGE 4-5
BASIC
INSTALLATION

PAGE 6-7
INSTALLATION OF
EXTRAS

PAGE 8
LOAD
CAPACITY

PAGE 9
SAFETY

PAGE 10
ANCHORING
TO
FLOOR

NOTE!

This publication is intended to be a generic installation instruction for Madix Wide Span, and may possibly be subject to change as required by local building codes ...consult the building inspection department at job site.

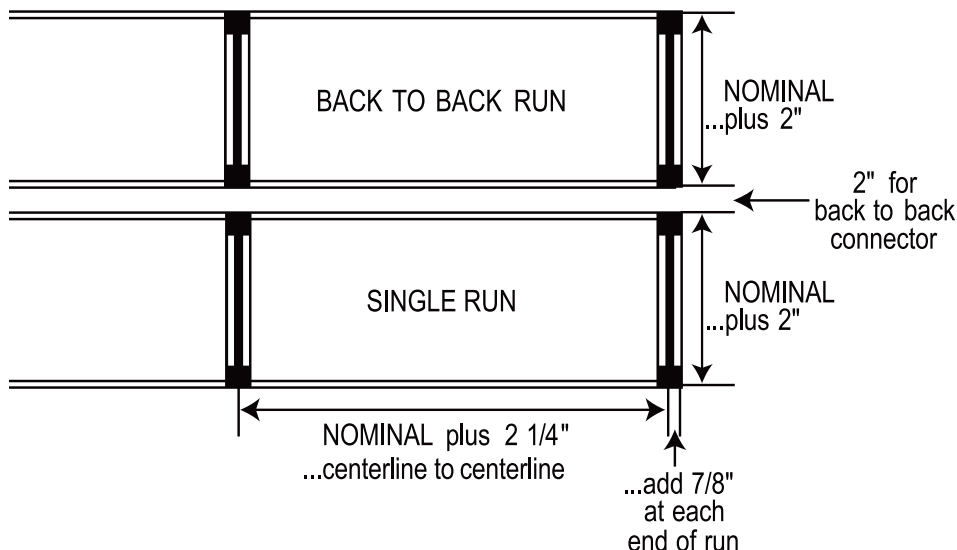

WIDE SPAN SHELVING

ASY 061

PARTS IDENTIFICATION

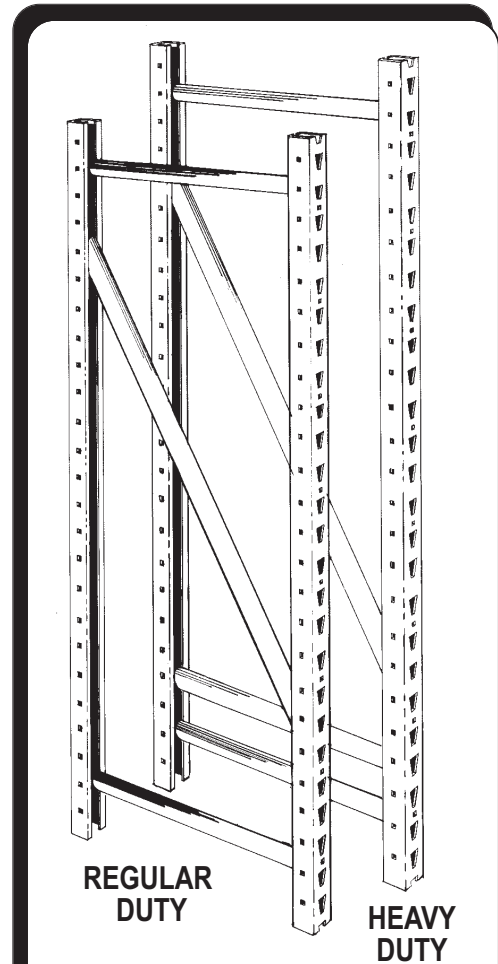
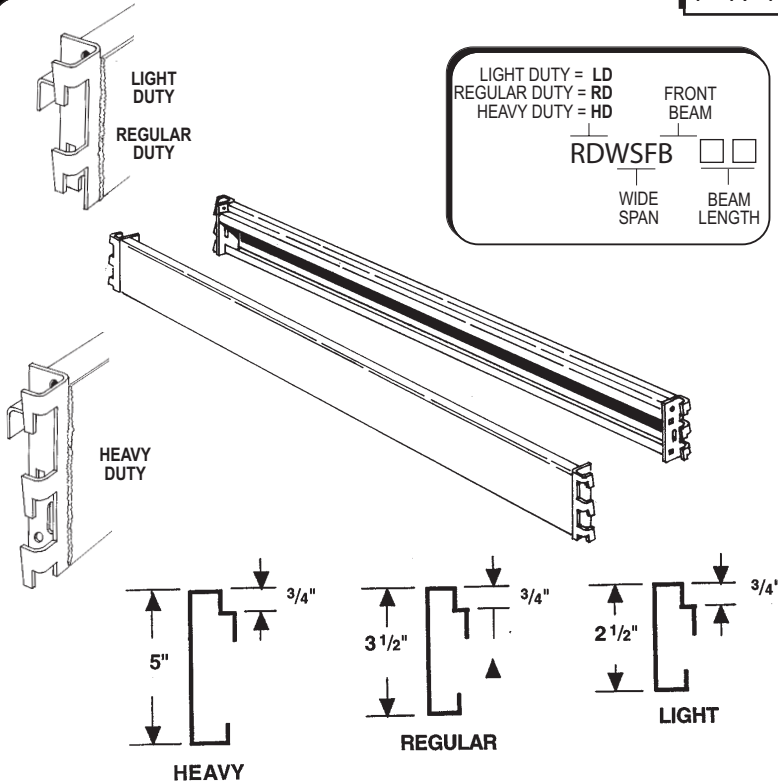

DIMENSIONS			
Deck Supports		Beams	
Frame Depth	Actual Length	Beam Length	Actual Length Inside of Brackets
18"	20"	48"	48 3/16"
24"	26"	60"	60 3/16"
30"	32"	72"	72 3/16"
36"	38"	84"	84 3/16"
42"	44"	96"	96 3/16"
48"	50"	-	-

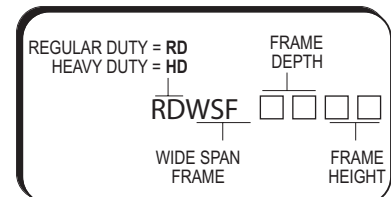
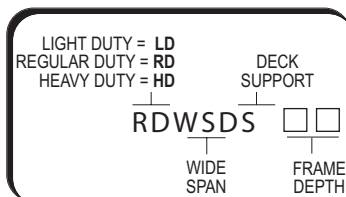

FRAME DIMENSIONS			
Frame Depth	Actual Depth	Frame Height	Actual Height
18"	20"	48"	48 "
24"	26"	60"	60"
30"	32"	72"	72"
36"	38"	84"	84"
42"	44"	96"	96"
48"	50"	108"	108"
-	-	120"	120"

WIDE SPAN SHELVING

ASY 061

PARTS IDENTIFICATION

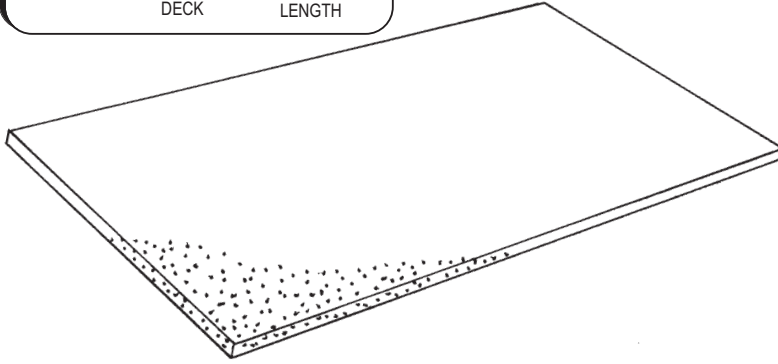
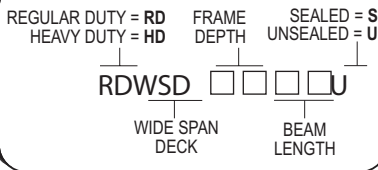

PARTICLE BOARD DECKS

...dimensions

Frame Depth	Actual Depth	Beam Length	Actual Length
18"	18"	48"	47 29/32"
24"	23 29/32"	60"	60"
30"	30"	72"	72"
36"	36"	84"	84"
42"	42"	96"	96"
48"	48"	-	-

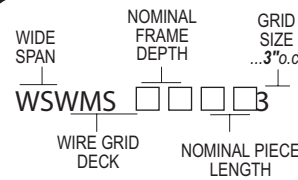
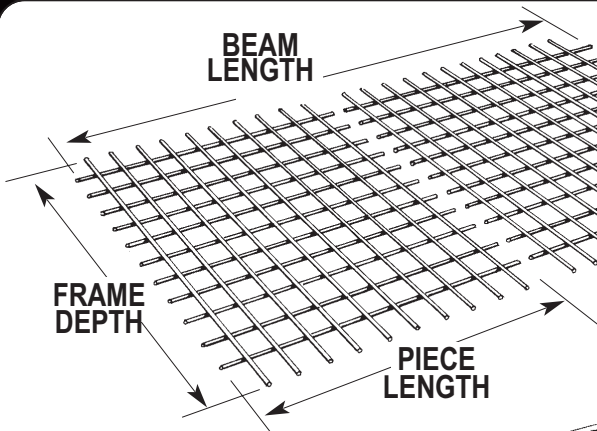

WIRE GRID

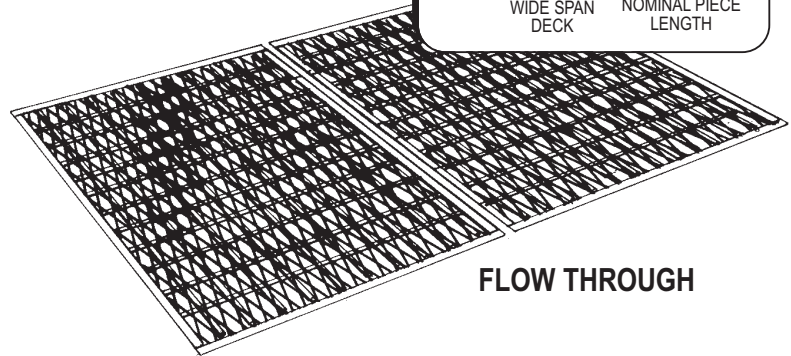
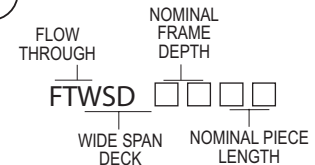

FLOW THROUGH

WIRE GRID DECKS, and FLOW THROUGH DECKS

...dimensions

Frame Depth	Actual Depth	Piece Length	Actual Length
18"	17 3/4"	24"	23 3/4"
24"	23 3/4"	36"	35 3/4"
30"	29 3/4"	48"	47 3/4"
36"	35 3/4"	-	-
42"	41 3/4"	-	-
48"	47 3/4"	-	-

WIRE GRID and FLOW THROUGH PIECE LENGTHS RUN PARALLEL TO BEAM LENGTHS

BEAM LENGTH	COMBINATIONS OF PIECE LENGTHS	# OF DECK SUPPORTS
36"	36"	2
48"	48"	2
60"	24" plus 36"	4
72"	36" plus 36"	4
84"	36" plus 48"	4
96"	48" plus 48"	4

WIDE SPAN SHELVING

PAGE 4 OF 10

ASY 061

BASIC INSTALLATION

1

Snap chalklines on floor as shown for shelving layout. See diagram on page one for dimensions.

2

Raise first frame to vertical position and install first beam...frame will now stand alone.

NOTE! If floor anchors or extension frames are to be used, they should be installed prior to raising frames to the vertical position...see pages 5-6.

3

Raise second frame to vertical and install free end of first beam... install second beam on opposite side.

4

Install upper beams at designated levels.

5

If using Dart Clips:

Press dart clips through beam bracket and upright on under side of beam as shown. Insert one dart clip at each end of all beams. Insert dart clip from inside upright if using LD beams.

If using Retainer Pins:

Insert one leg of a retainer pin through beam bracket and upright. Insert one pin at each end of all beams.

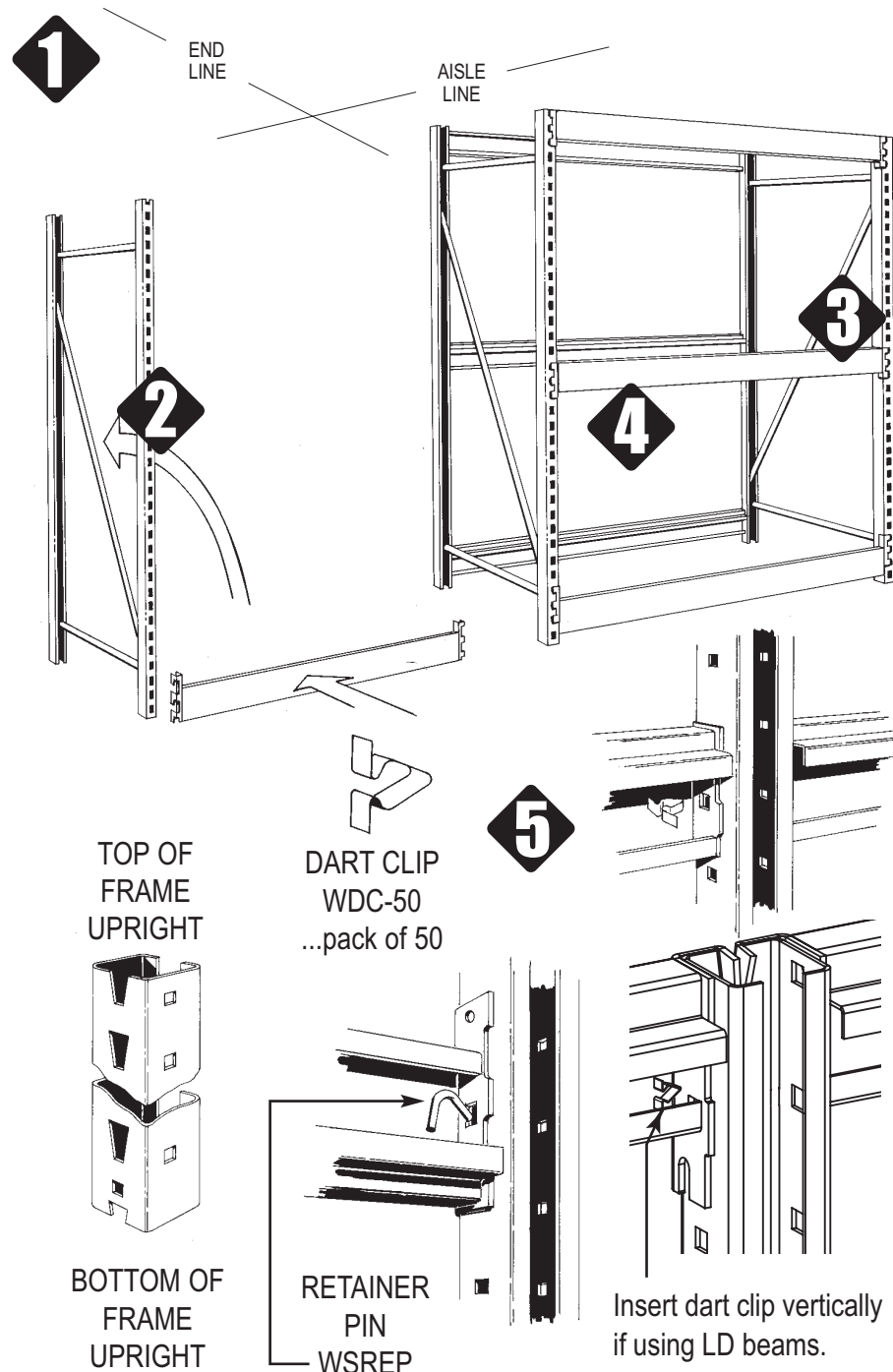

NOTE: Retainer pins and dart clips serve the same purpose - to retain beam connections

IMPORTANT: ANY BEAM USED AS A PRODUCT RETAINER MUST BE BOLTED THROUGH BOTH UPRIGHTS.

WIDE SPAN SHELVING

ASY 061

BASIC INSTALLATION

6

Repeat assembly sequence with remaining frames, beams and dart clips/retainer pins.
NOTE! If back to back runs are being installed, see page 6 for back to back connectors.

7

Holding the deck support at an angle to the beam, squeeze the open side and insert into the beam, then swing the free end around to the opposite beam, squeeze the open side and insert into the beam.

8

Squeeze the open side of the deck support at each end just inside the beam and rotate upwards as shown.

9

Correct installed position will look like this...see above for quantity of deck supports per beam length.

10

Repeat with the remaining deck supports in the shelving run.

11

Install all decks in the shelving run.

DECK SUPPORTS... QUANTITY & LOCATION

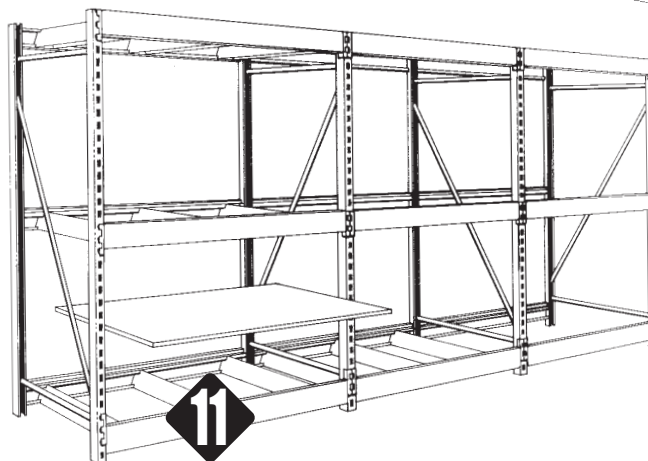
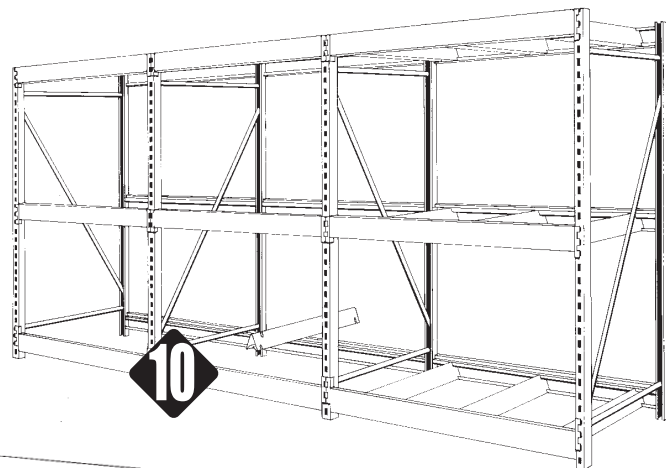
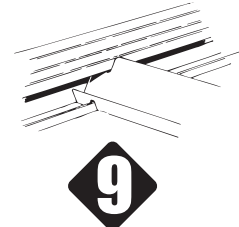
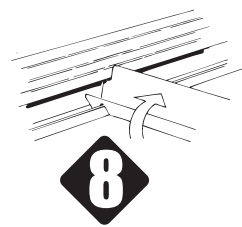
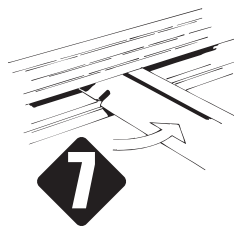
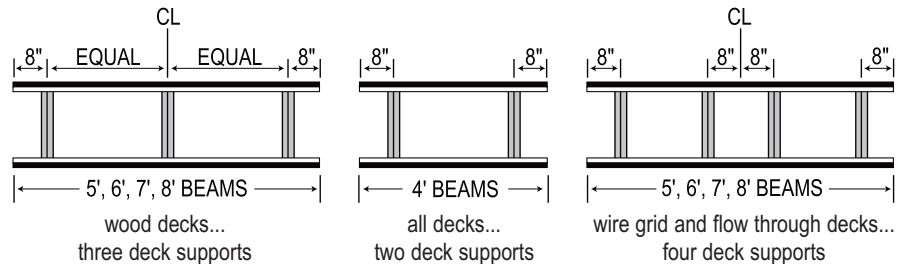

WIDE SPAN SHELVING

ASY 061

INSTALLATION OF EXTRAS

12

The first sections of the back to back run should be erected with beams at top and bottom of the four frames. Locate the connectors just below the top beams and just above the bottom beams. Secure with the fasteners as shown.

13

Repeat with the remaining sections.

14

Install all intermediate beams as required, then install a third connector as close as possible to the mid-point of the frames. Complete the shelving run with the deck supports and decks.

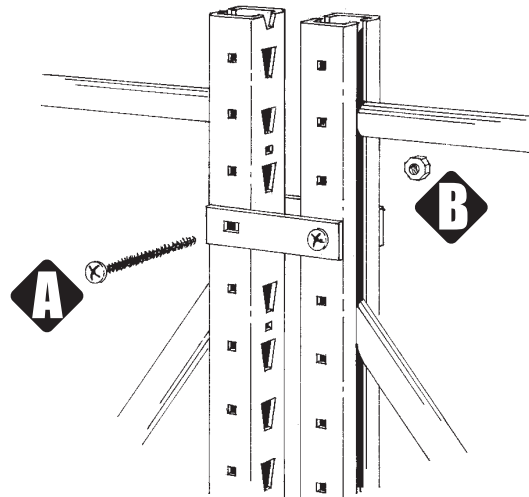

BACK TO BACK
CONNECTOR
WSBBC-2-24

WSBBC-2-24 HARDWARE PACK #7200-079

QTY.	ITEM DESCRIPTION
A 48	1/4 - 20 x 2 1/4" carriage bolt
B 48	1/4 - 20 wing nut

A ...indicates item, where used.

15

In the sixth square hole from the top of the lower frame, insert a stop to prevent the connector from dropping to the floor.

16

Insert connector into frame with flat center of connector facing the slotting.

17

Screw connector to lower frame with provided fasteners...remove the stop.

18

Repeat above with the 2nd upright of the frame.

19

Lower upper frame onto connectors and secure through the sixth hole up from the joint.

FRAME
CONNECTORS
WSFC-2

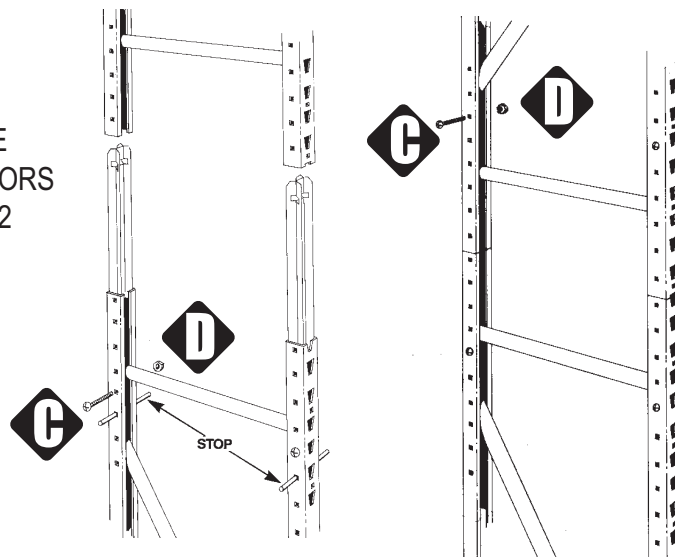

WSFC-2 HARDWARE PACK #7200-078

QTY.	ITEM DESCRIPTION
C 4	1/4 - 20 x 2" Phillips truss head machine screw
D 4	1/4 - 20 hex nut

C ...indicates item, where used.

WIDE SPAN SHELVING

PAGE 7 OF 10

ASY 061

FLOOR ANCHOR WSFA-2

INSTALLATION OF EXTRAS

NOTE! IF FRAME HEIGHT, OR TOTAL HEIGHT OF CONNECTED FRAMES, IS MORE THAN SIX TIMES THE FRAME DEPTH ...FRAMES MUST BE SECURED WITH FLOOR ANCHORS.

20

Insert floor anchors into the bottom of each frame. They will only insert at 45° to the frame. Make sure that anchors are inserted so that they will not project into aisles or cross aisles.

21

Follow directions on page 4 to step 6, except do not install dart clips on bottom beams. Secure beams to frames through the floor anchor as shown. The screw will go through at one of the two locations, depending on the beam size.

22

Check run alignment to chalkline prior to drilling floor for expansion bolts. Due to varying floor conditions, expansion bolts must be ordered separately. If they were not ordered initially, but are required, see page 8 to order from Madix or purchase locally.

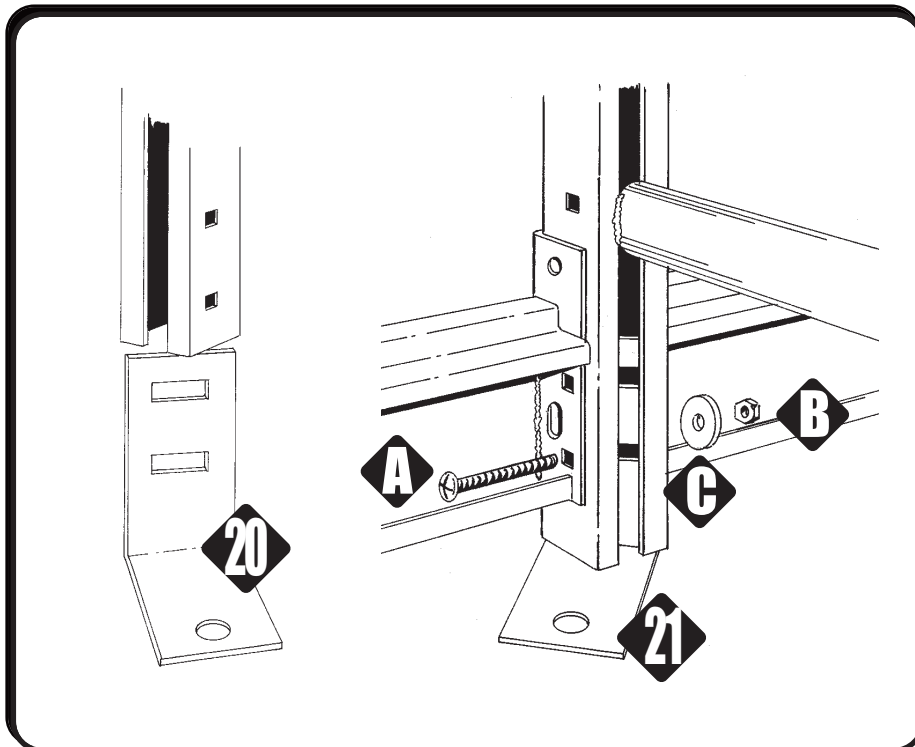

LEVELING SHIM

WSLS-10C

Ten pack of galvanized shims...dimpled to fit in bottom of upright and maintain stacking interlock.

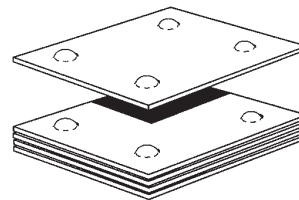

TOP CAP

WSTC - □ -CL

Packs of 4 or 48 clear plastic top caps, two per frame. Tap into top of each frame upright.

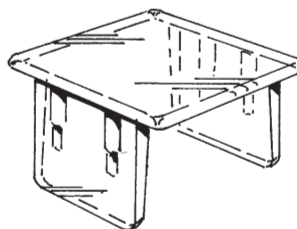

WSFA-2 HARDWARE PACK #7200-080

QTY.	ITEM	DESCRIPTION
2	A	1/4 - 20 x 2 1/2" round head machine screw
2	B	1/4 - 20 hex nut
2	C	1/4" flat washer

A...indicates item, where used.

WIDE SPAN SHELVING

ASY 061

L O A D S A F E T Y



HAND STACK ONLY!
POWERED FORK TRUCKS
OR STACKERS ARE NOT
RECOMMENDED FOR USE
ON WIDE SPAN SHELVING

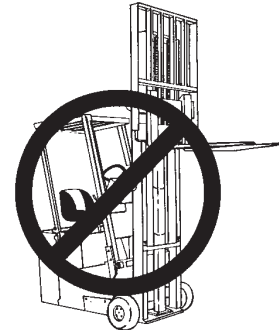

FRAME LOADING

Frame loading is the vertical load, measured in pounds, that can be applied on any Wide span frame. Each Wide span frame will bear ONE HALF OF THE LOAD ON EACH BEAM PAIR that it supports. ALL FRAMES HAVE 10,000 POUND LOAD CAPACITY!

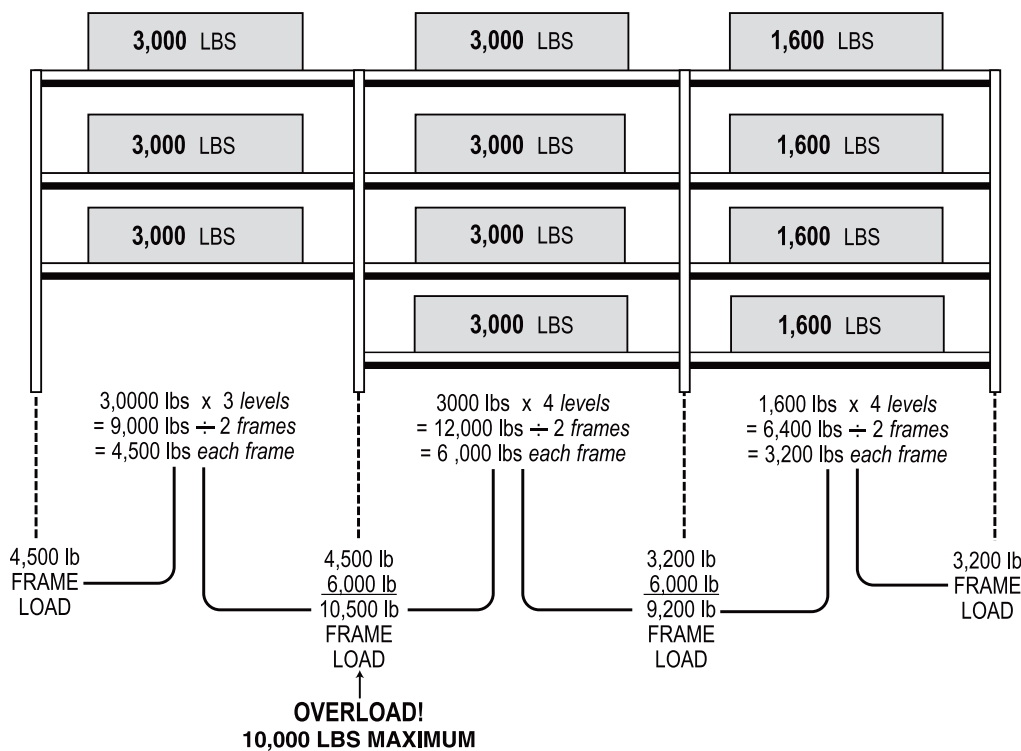

Height to Depth Ratio:
Ratio should not exceed 6 to 1 measuring to the top of top most load. If ratio exceeds 6 to 1 the constraint can be overcome with proper anchoring or external bracing of the rack structure. **CONSULT YOUR STRUCTURAL ENGINEER FOR SOLUTIONS.**

MAXIMUM BEAM LOAD CAPACITY ...PER BEAM PAIR

- Based on evenly distributed loads
- Based on 96" beam length, all frame widths

BEAM LENGTH	LIGHT DUTY	REGULAR DUTY	HEAVY DUTY	# OF DECK SUPPORTS (WOOD DECK)	# OF DECK SUPPORTS (WIRE DECK)
48"	1000 #	1600 #	3000 #	2	2
60"	1000 #	1600 #	3000 #	3	4
72"	1000 #	1600 #	3000 #	3	4
84"	1000 #	1600 #	3000 #	3	4
96"	1000 #	1600 #	3000 #	3	4

GENERAL

1. Contact the local building department prior to starting installation to check on any restrictions.
2. Only parts and accessories produced or supplied by Madix are covered by Madix warranty.
3. Installation sequence must be followed exactly for assembly and leveling.
4. Under no circumstances should damaged parts be used.
5. Do not use shelving parts or accessories for any purpose other than originally intended.
6. Installation instructions with product load ratings are included with each order and must be followed carefully.
7. Merchandisers must be made aware of possible overloading as specified in load ratings. If you do not receive these, please contact your sales or customer service representative.
8. Initial installation or relocation of Madix gondola, wall or racking fixtures should be supervised exclusively by qualified personnel.

RACKING... FRAMES / BEAMS

9. Observe all prohibitions in the installation instructions on the use of powered lifts.
10. A minimum of four people are required to erect frames taller than 8'.
11. Be sure all beams or accessories are completely seated and locked or secured in frame slotting.
12. Ladders, if used, should be at least frame height.
13. Never stand on lower beams to install upper beams.
14. Do not walk on decks, especially wire grid.
15. Never try to move a completed racking run, especially if merchandised.

WIDE SPAN SHELVING**ASY 061**

ANCHORING TO THE FLOOR

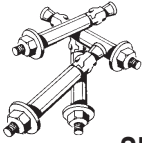
**EXPANSION BOLTS FOR FLOOR ANCHORS**

...50 expansion bolts, 1/2"-13 x 3 1/2" POWERS/ Power-Stud+SD2 concrete anchors or other ICC (ICBO) approved expansion bolts.

SFA-EB-12-334: See below for other ICC (ICBO) approved expansion bolts which may be used.

NOTE! The expansion anchors provided by Madix for floor anchoring at this site have been supplied by one of the firms listed below. All the anchors have been tested and approved as stated by the following ICC (ICBO) report numbers and all are manufactured in the United States or Canada. If the anchors are not provided by Madix and field substitution other than listed be proven, Madix cannot be held responsible. Should verification be required, call Madix Customer Service at: **800.776.2349**

	ICC (ICBO) #
COBRA ANCHORS CORP., Parawedge concrete anchors	ER-2350 S1
DIVERSIFIED FASTENING SYSTEMS, DFS Wedge anchor	ER-4194 S1
GUNNEBO FASTENING CORP., Drop-in concrete anchors	ER-3219 S1
HILTI, INC., Kwik-bolt-TZ concrete anchors	ESR-1917
MKT FASTENING, High Load Anchor SZ	AC-193
ITW RAMSET/RED HEAD, ITW Ramset stud, Trubolt wedge concrete anchors	ESR-2251
MARKSMAN MANUFACTURING CO., Thunderstud wedge and sleeve anchor	ER-2713 S1
POWERS FASTENING INNOV., Power-Stud+SD2 concrete anchors	ESR-2502
WEJ-IT, Wej-it anchors bolt and ANKR-TITE wedge anchor	ER-1825
CYW, INC., POWER BULL, Wedge anchor	ESR-2254

*Embedment must be minimum 5x bolt diameter.

OTHER ICC (ICBO) APPROVED ANCHORING MATERIALS... not furnished by Madix**PNEUMATIC OR POWDER-DRIVEN STEEL STUDS AND NAILS**

HILTI, INC., Hilti low velocity powder actuated or pneumatically driven fasteners	ESR-1663
ITW RAMSET/RED HEAD, Ramset Powder-Actuated and PowerPoint fasteners	ESR-1799

ADHESIVE/ EPOXY ANCHORS

HILTI, INC., HIT-HY 150 Adhesive anchor system	ESR-2678
ITW RAMSET/RED HEAD, ITW Red Head Epcon system Ceramic 6+ epoxy anchors	ESR-3577



P.O. BOX 729 / TERRELL, TEXAS 75160 / 972.563.5744 / 800.776.2349
P.O. BOX 177 / GOODWATER, ALABAMA 35072 / 205.839.6354 / 800.633.6282

REV
06

REV#	ECN#	REVISION	BY	DATE	REV#	ECN#	REVISION	BY	DATE
01	5-13950	UPDATED TO CORRECT ANCHOR INFO	SAM	1/7/14	04	5*18143	ADDED BOLTING REQ. TO PG 4	NRD	09/12/16
02	5*14150	ADDED HEIGHT/DEPTH RATIO	CAB	02/14/14	05	5*21426	UPDATED 1/2" - 13 BOLT, PG 10	HER	05/14/19
03	5*16478	SHOWED LD BEAM DART CLIP ON PG 4	TED	06/29/15	06	5*23046	UPDATED DECK SUPPORT #'S, PAGE 8	JPP	09/03/20